

Name: \_\_\_\_\_  
 Date of birth: \_\_\_\_\_  
 Sampling date: \_\_\_\_\_  
 Doctor: \_\_\_\_\_

Name: \_\_\_\_\_  
 Date of birth: \_\_\_\_\_  
 Sampling date: \_\_\_\_\_  
 Doctor: \_\_\_\_\_

GGD Amsterdam  
 Streeklaboratorium  
 Postbus 2200  
 1000 CE Amsterdam

**GGD Amsterdam**  
 Streeklaboratorium  
 Nieuwe Achtergracht 100  
 1018 WT Amsterdam  
 Monday to Friday 08:30-17:00

[www.streeklaboratorium.nl](http://www.streeklaboratorium.nl)  
[sla@ggd.amsterdam.nl](mailto:sla@ggd.amsterdam.nl)  
 020 555 5275

## Stool collection 2

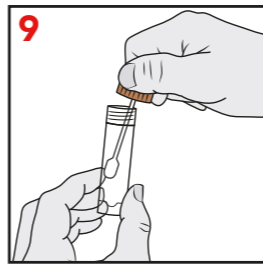

9 Open the container with the scoop.

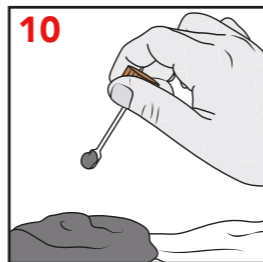

10 Scoop the stool and fill the container half full.

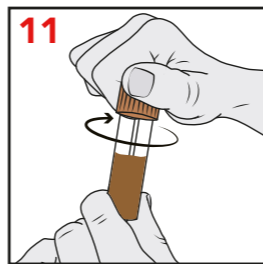

11 Put the scoop with the stool in the container. Tighten the cap firmly.

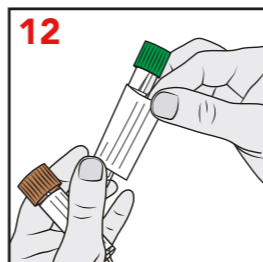

12 Attach the label with your details to the tube and the container.

## Packaging and shipping

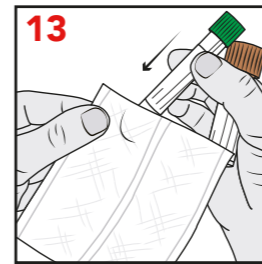

13 Put the tube and the container in the white pouch.

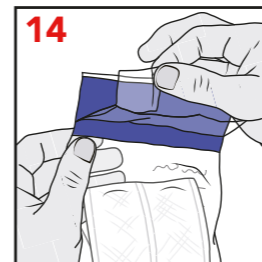

14 Put the white pouch in the plastic bag. Close it by using the adhesive edge.

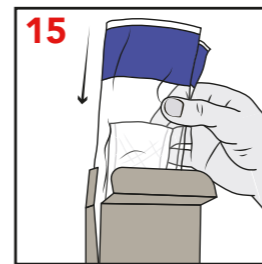

15 Put the plastic bag in the box. Close the box.

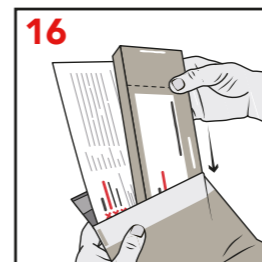

16 Attach the GGD address label on the back of the envelope, at the bottom left. **Put the box and the form from your doctor in the envelope.** Close it by using the adhesive edge.



17 Drop off the envelope at an Atalmedial sampling location. Look for a nearby address at [www.atalmedial.nl](http://www.atalmedial.nl) or send the envelope by post. A stamp is not required.



## Instruction manual



This test is for examining gastrointestinal complaints.

## Instruction manual

This test is for examining gastrointestinal complaints.

The test requires the collection of stool.

### A. Read the full explanation

The explanation can be found on the front and back of these instructions.

### B. Check to see that everything is in the box

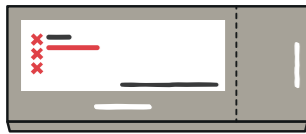

Box

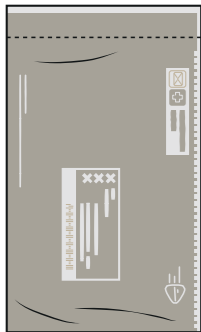

Envelope

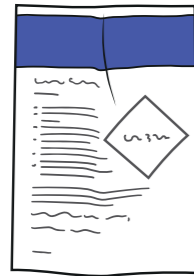

Plastic bag



Tube and cotton swab



Container with scoop



White pouch

### C. Important

- Do not open the packages until you start the test.
- The tube contains a liquid. This liquid must remain in the tube. There is a liquid in the tube.
- Do not touch the cotton part.
- No water or urine should be allowed to contaminate the stool. Always use fresh stools.

### D. Getting ready



There are 2 labels on the back. **Write your name, date of birth, sampling date, and the name of your doctor on it.**

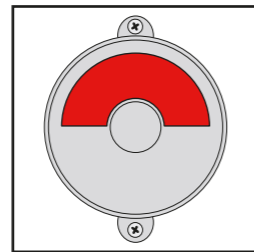

Go to the toilet.



No water or urine should be allowed to contaminate the stool.

You should therefore put a ball of toilet paper in the toilet bowl.



Work as neatly as possible. Remove your underpants. Wash your hands with soap and water.

Dry your hands with a clean hand towel.

### Stool collection

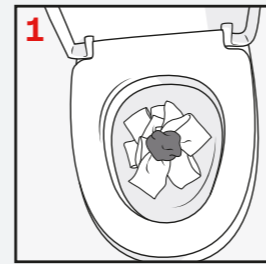

Make sure the stool falls on the paper.

When using a nappy or incontinence products, pick up the stool immediately after it has been produced.

### Unpacking

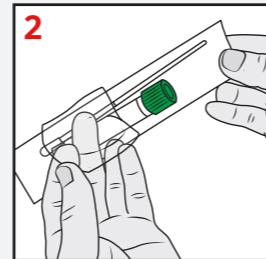

Open the packaging of the tube and the cotton swab.

Do not touch the cotton part.

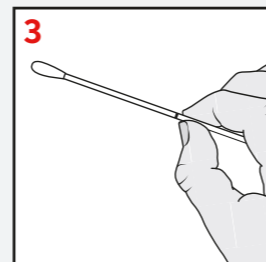

Hold the swab at the line.

### Stool collection 1

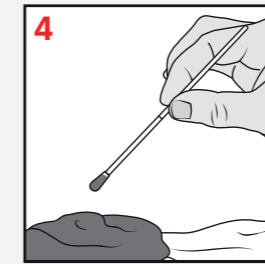

Push the cotton wool into the stool.

Make sure the cotton wool is completely covered.

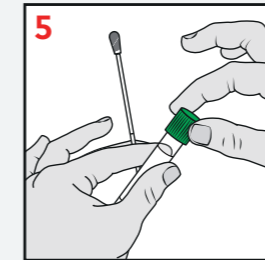

Keep holding the cotton swab. Do not touch the cotton part.

Take the tube and unscrew the cap.

Leave the liquid in the tube.

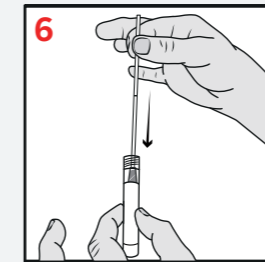

Put the cotton swab into the tube.

The swab is longer than the tube.

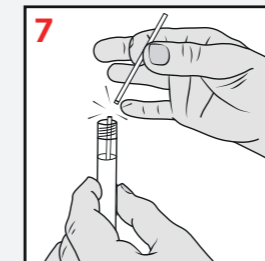

Carefully break off the upper part at the line.

Use the inside of the tube for this.

Discard the piece that was broken off.

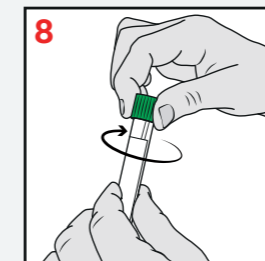

Tighten the cap firmly.